

# MOTOR GUARD CORPORATION

## MODEL AD-1000 AUTOMATIC DRAIN

### INSTALLATION

The AD-1000 Automatic Drain is designed to drain accumulated water and oil from drain lines, condensate drop legs, receiver tanks and filters. The unit features a top threaded port for ease of installation. A protective stainless steel screen, umbrella baffle and large sump area collect moisture, oil sludge and dirt. An internal float drain automatically empties bowl of accumulated liquid while minimizing air loss.

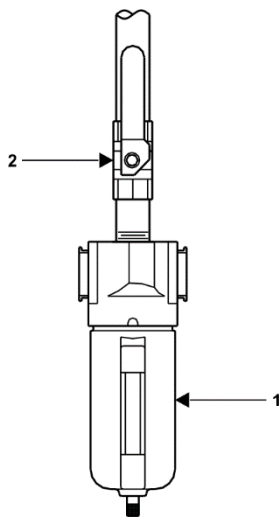

#### FEATURES

- Highly Visible, Ball-Float Type Sight Glass
- Stainless Steel Screen
- Non-Clogging Float-Type Drain

#### SPECIFICATIONS

Operating Temperature Range:	40 -120 F
Maximum Inlet Pressure:	175 PSI
Port Size:	1/2 NPT

Before installing unit, relieve upstream pressure completely. Install unit (1) at lowest point in system and at the bottom of long vertical drops. Slope adjacent piping toward drain for best results. Install manual shut-off valve (2) (field supplied) upstream of unit to facilitate service. Unit is designed for installation in a 1/2" line, use appropriate fittings for installation in other line sizes. Apply pipe thread compound to male thread connections. Install unit level with drain facing down.

**WARNING: This product is intended for use on industrial compressed air systems only. It is not to be used on life support or breathing air systems. Do not install where pressures or temperatures can exceed those listed above.**

### OPERATION

Before pressurizing, be sure bowl is turned fully clockwise. Pressurize slowly to avoid high-pressure surge.

Inspect daily for leaks.

# MAINTENANCE

**WARNING:** Shut off air supply and drain residual pressure before attempting to service any part of the system!

## Screen Cleaning

The filter screen is intended to trap large particles and should be removed regularly for cleaning. Remove and clean with mild detergent, drying completely before replacing.

## Float Valve Cleaning

If the drain remains open continuously it will be necessary to remove and clean the float valve assembly. Remove bowl and invert. Grasp drain nipple with pliers and rotate clockwise until float valve drops out. Inspect O-ring and replace if necessary. Soak valve assembly in mild detergent for several hours. Blow dry with light air and reassemble.

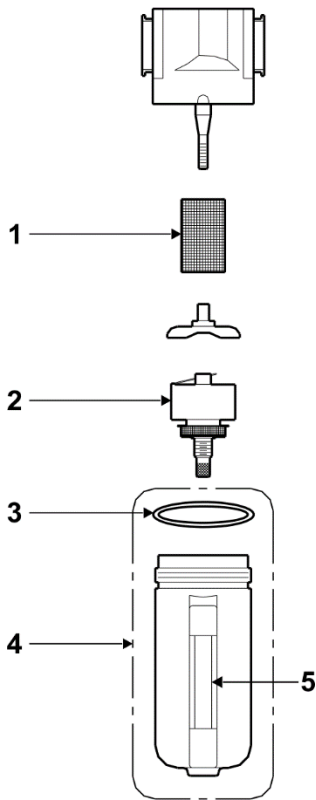

## Replacement Parts

Key	Part No.	Ord. No.	Description	Qty.
1			Screen	1
2	AS4054	74054	Automatic Drain, Float	1
3	RK4047	74047	O-Ring, Bowl, Std. Flow	1
4	EL4003	74003	Bowl Kit w/ Sight, Std. Flow	1
5	RK4204	74204	Sight Tube Kit, Std. Flow	1

### Build a Complete System with these Air Management Products from Motor Guard

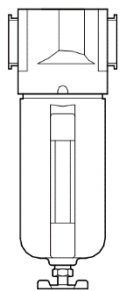

**PARTICULATE  
AIR FILTER  
AF-4515**

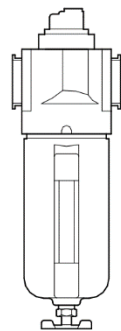

**OIL REMOVING  
FILTER  
CO-4515**

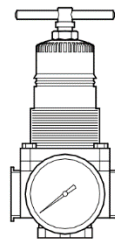

**PRECISION  
AIR REGULATOR  
RG-4520**

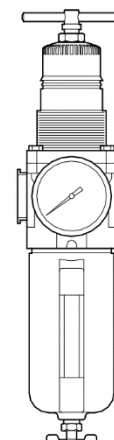

**COMBINATION  
FILTER/REGULATOR  
AC-4525**

**Economical Solutions to All Your Shop Air Needs**