

MOTOR GUARD CORPORATION

MODEL AF-4510 PARTICULATE FILTER

INSTALLATION

The AF-4510 Particulate Air Filter removes water, dust and debris from air lines, protecting air tools and system components from premature failure.

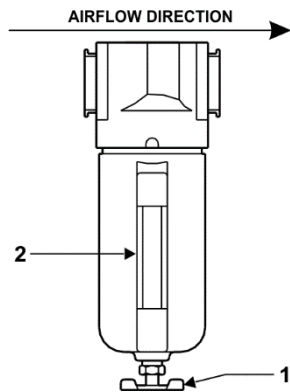

FEATURES

- 40 Micron Sintered Bronze Replaceable Element
- Highly Visible, Ball-Float Type Sight Glass
- Non-Clogging Manual Drain

SPECIFICATIONS

Maximum Airflow:	100 CFM
Operating Temperature Range:	40 -160 F
Maximum Inlet Pressure:	250 PSI
Port Size:	1/2 NPT

Before installing unit, relieve upstream pressure completely. Install unit level with drain facing down. Install unit in air supply line upstream of regulators and lubricators. Unit should be installed as close as possible to the tools or appliances served. Install so that airflow is in the direction indicated by the arrow on top of the unit. Unit is designed for installation in a 1/2" line. Use appropriate fittings for installation in other line sizes. Apply pipe thread compound to male thread connections.

WARNING: This product is intended for use on industrial compressed air systems only. It is not to be used on life support or breathing air systems. Do not install where pressures or temperatures can exceed those listed above.

OPERATION

Before pressurizing, be sure bowl is turned fully clockwise. Pressurize slowly to avoid high-pressure surge.

Inspect daily for leaks.

Check level of accumulated liquid daily at sight glass (2) and drain moisture by turning drain cock (1) counter-clockwise.

MAINTENANCE

Filter Cleaning

Wash filter element regularly with kerosene to maintain filtration efficiency. To clean element, depressurize system, unscrew bowl and remove element and baffle. Wash element and dry thoroughly before replacing. Wash sludge and sediment from bowl with warm soapy water. Inspect O-ring and replace if damaged or distorted. Reassemble bowl, taking care not to damage threads. After bowl is tightened it may be rotated up to 180° for proper viewing.

WARNING: Shut off air supply and drain residual pressure before attempting to service any part of the system!

Filter Replacement

Follow procedure outlined above for the replacement of the filter element.

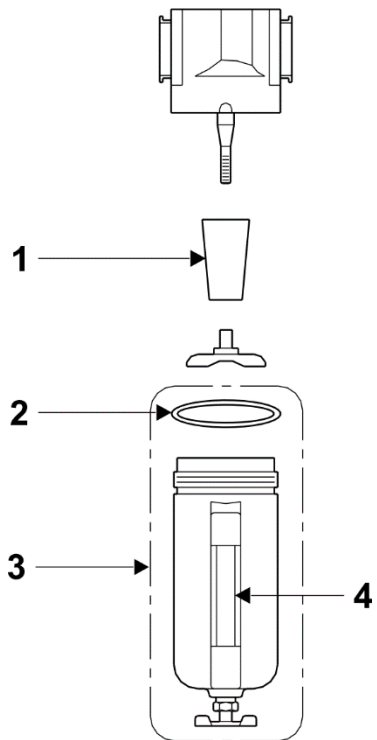

Replacement Parts

Key	Part No.	Ord. No.	Description	Qty.
1	EL4026	74026	Element, Particulate, 40 Micron	1
2	RK4047	74047	O-Ring, Bowl, Std. Flow	1
3	EL4003	74003	Bowl Kit w/ Sight, Std. Flow	1
4	RK4204	74204	Sight Tube Kit, Std. Flow	1

Build a Complete System with these Air Management Products from Motor Guard

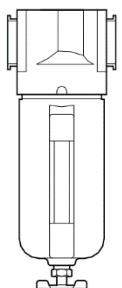

**PARTICULATE
AIR FILTER
AF-4515**

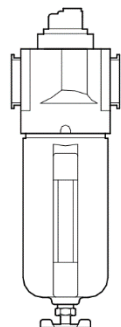

**OIL REMOVING
FILTER
CO-4515**

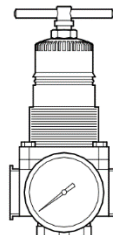

**PRECISION
AIR REGULATOR
RG-4520**

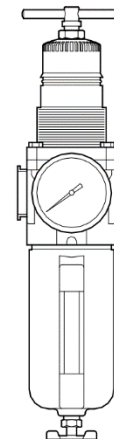

**COMBINATION
FILTER/REGULATOR
AC-4525**

Economical Solutions to All Your Shop Air Needs