

MOTOR GUARD

FLEXIBLE SANDING BAR COLLECTION

NEW FROM MOTOR GUARD

FLEXI-BLOCK™

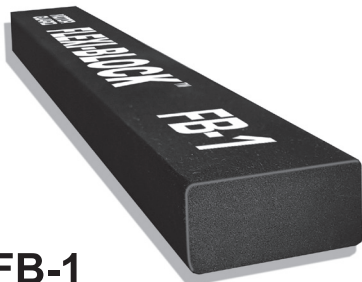

FB-1
Rectangular Sanding Bar

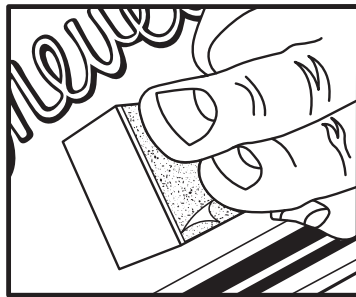

Sanding a narrow flat area

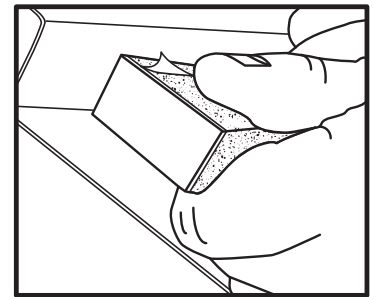

Sanding a sharp inside corner

A rectangular sanding bar made for sanding narrow flat areas not suited for standard blocks. This bar is also perfect for sanding tight inside corners. Also flexes enough to follow slight curves.



FB-2
Double-D Sanding Bar

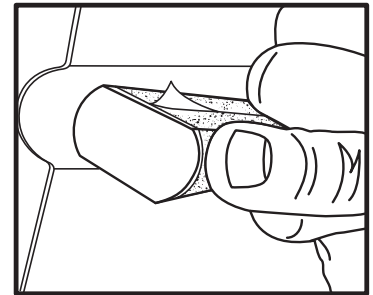

Sanding an inside curve

A flexible sanding bar with two radiused sides is ideal for sanding inside contours. This block also eliminates the pressure points that occur with sharp-edged blocks.

A completely unique sanding bar with multiple inside and outside curves for sanding complex character lines and details. Rotate this block to find just the right sanding surface.



FB-3
Curved Sanding Bar

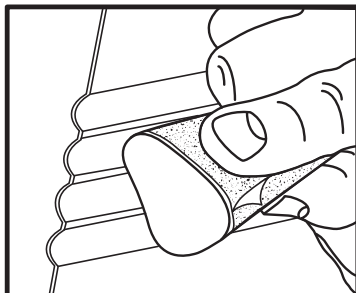

Sanding a detailed inside curve

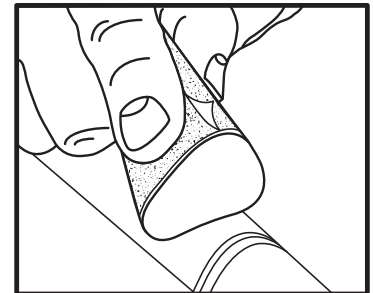

Sanding an outside curve

MOTOR GUARD CORPORATION

MANTECA, CALIFORNIA • (209) 239-9191 • FAX (209) 239-5114 • www.motorguard.com

Printed in U.S.A. S1122 07/17

MOTOR GUARD

FLEXIBLE SANDING BAR COLLECTION

NEW FROM MOTOR GUARD

FLEXI-BLOCK™

FLEXIBLE SANDING BARS

Flexi-Block™
Assortment



Three Shapes to Handle All Detail
Sanding from Grooves &
Channels to Contours
& Character Lines

Motor Guard has introduced a first of its kind line of flexible sanding bars for detail sanding applications. These new blocks are constructed of a dense yet flexible compound that allows bending to suit body profiles while maintaining a firm and durable backing for highly effective sanding. Each bar measures 11 inches in length.

Motor Guard's new **Flexi-Blocks™** are available in three styles, the **Rectangular Block (FB-1)** for flat sanding and sharp corners, the **Double D Block (FB-2)** with radiused sides for sanding inside contours, and the **Curved Block (FB-3)** for complex body lines and details. The blocks are also offered in a see-through pegboard display of all three, the **AP-6 Flexi-Block™ Assortment**.

From Pulling to Painting, **Motor Guard Corporation** is celebrating fifty years of providing time-saving and innovative solutions to the auto body repair and refinishing professional.

Users of these unique Sanding Blocks report reduced paint prep times, reduced material consumption and increased paint department productivity.



AP-6 Flexi-Block™ Assortment
See-Through
Retail Display
Order No. 00709

Rectangular Block (FB-1) for flat sanding and sharp corners
Order No. 00706

FB-1

Double D Block (FB-2) with radiused sides for sanding inside contours
Order No. 00707

FB-2

Curved Block (FB-3) for complex body lines and details
Order No. 00708

FB-3

MOTOR GUARD CORPORATION

MANTECA, CALIFORNIA • (209) 239-9191 • FAX (209) 239-5114 • www.motorguard.com

Printed in U.S.A. S1122 07/17