

MOTOR GUARD CORPORATION

MODEL MHT-7300 HIGH TECH COMPRESSED AIR REGULATOR

INSTALLATION

The MHT-7300 High Tech Compressed Air Regulator is a high-capacity, true-diaphragm regulator for spray booths and critical refinishing operations.

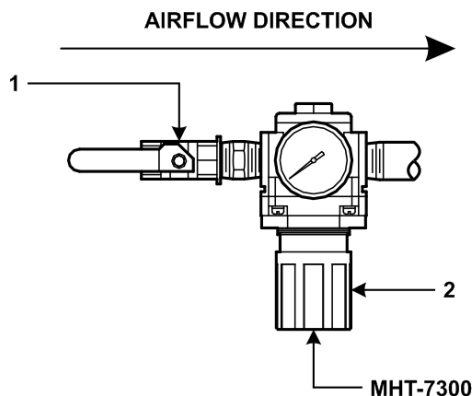

FEATURES

High-capacity, true diaphragm regulator designed to set and hold pressure over a wide range of flows and conditions. High-visibility, multi-scale pressure gauge features a scratch and solvent resistant glass lens. Large, ergonomic adjustment knob locks to hold pressure setting.

SPECIFICATIONS

Inlet/Outlet Size:	1/2 NPT
Nominal Airflow Rating:	30 SCFM
Maximum Inlet Pressure:	125 PSIG
Outlet Pressure Range:	2-125 PSI
Operating Temperature Range:	40-120 °F

Install unit in spray booth or near critical operation. A water/trap filter installed upstream of the unit will protect the unit from contamination which could lead to improper operation. Unit is designed for installation in a 1/2" line; use appropriate fittings for installation in other line sizes. Apply pipe thread compound to male thread connections. Before installing unit, relieve upstream pressure completely. Install unit level and in direction of airflow as noted. Unit should be mounted to a rigid structure and should not be supported by the supply line.



WARNING: This product is intended for use in industrial compressed air systems only. Do not install where pressures or temperatures can exceed those listed above. Not for use on breathable air applications.

Unit is supplied ready for use. Install pressure gauge on open port using pipe sealing compound or tape. Installation of a supply valve (not provided) can be used to isolate unit during servicing and adjustment.

Pressurize slowly to avoid high-pressure surge.

OPERATION

Open service valve (1) fully so that handle is parallel to inlet pipe. Turn knob on regulator clockwise to increase air pressure, counter-clockwise to decrease. To reduce pressure setting, first reduce pressure to a setting lower than desired, then increase to the desired setting. Push knob up firmly to lock and prevent accidental adjustment.

Inspect daily for leaks.

Regulator should be disassembled, cleaned and serviced periodically.

580 CARNEGIE STREET
MANTECA, CA 95337

1-800-227-2822
FAX 209-239-5114

www.motorguard.com

MAINTENANCE



WARNING: Shut off air supply and drain residual pressure before attempting to service any part of the system!

On detection of air leaks, pressure fluctuation or pressure creep, depressurize system and remove bottom cap. Inspect valve seat and diaphragm (2) for damage or wear. Inspect seat in head casting for foreign material or damage. Clean with kerosene and blow out with air. Replace any damaged parts.

If leak persists, remove bonnet and inspect diaphragm and seat for wear or foreign materials.

To replace diaphragm, remove four screws holding bonnet. Remove diaphragm and spring. Clean diaphragm seat and replace diaphragm and spring. Replace bonnet and reinstall screws. Tighten gradually and firmly.

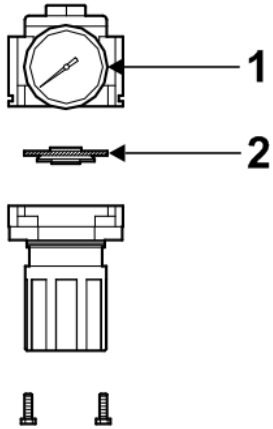

Replacement Parts

Key	Part No	Description	Qty.
1	RG4045	Pressure Gauge	1
2	RK7300	Diaphragm Kit	1

LIMITED WARRANTY

Motor Guard Corporation assumes the responsibility of providing equipment that is free from defects in workmanship and material. Should this product fail due to a defect in workmanship or material, Motor Guard Corporation will repair or, at its option, replace the product without charge, other than the transportation charges, provided that the product is returned to the factory, transportation prepaid, within one year of the date of purchase. Please contact Motor Guard Corporation for return authorization and shipping instructions.

This limited warranty does not cover damage to the product due to neglect, misuse or accident, nor does it cover any loss, damage or expense, either direct, indirect or consequential, arising from the non-function of this product. This limited warranty notice replaces any other warranty information, implied or otherwise, enclosed with this product or appearing in literature referring to this product.